

**PARTIAL FOUNDATION AND FLOOR PLAN**  
 SCALE: 1/8"=1'-0"

NOTE:  
 CONSULT LOCAL HEALTH AND  
 BUILDING CODE AUTHORITIES  
 BEFORE STARTING CONSTRUCTION

<b>LSU</b> <b>AgCenter</b> <small>Research &amp; Extension</small>		
<b>CONFINEMENT BEEF BARN</b>		
ILL. '73	<b>6156</b>	SHEET 1 OF 4

BASED ON: UNIV. OF ILL. PLAN NO. 566

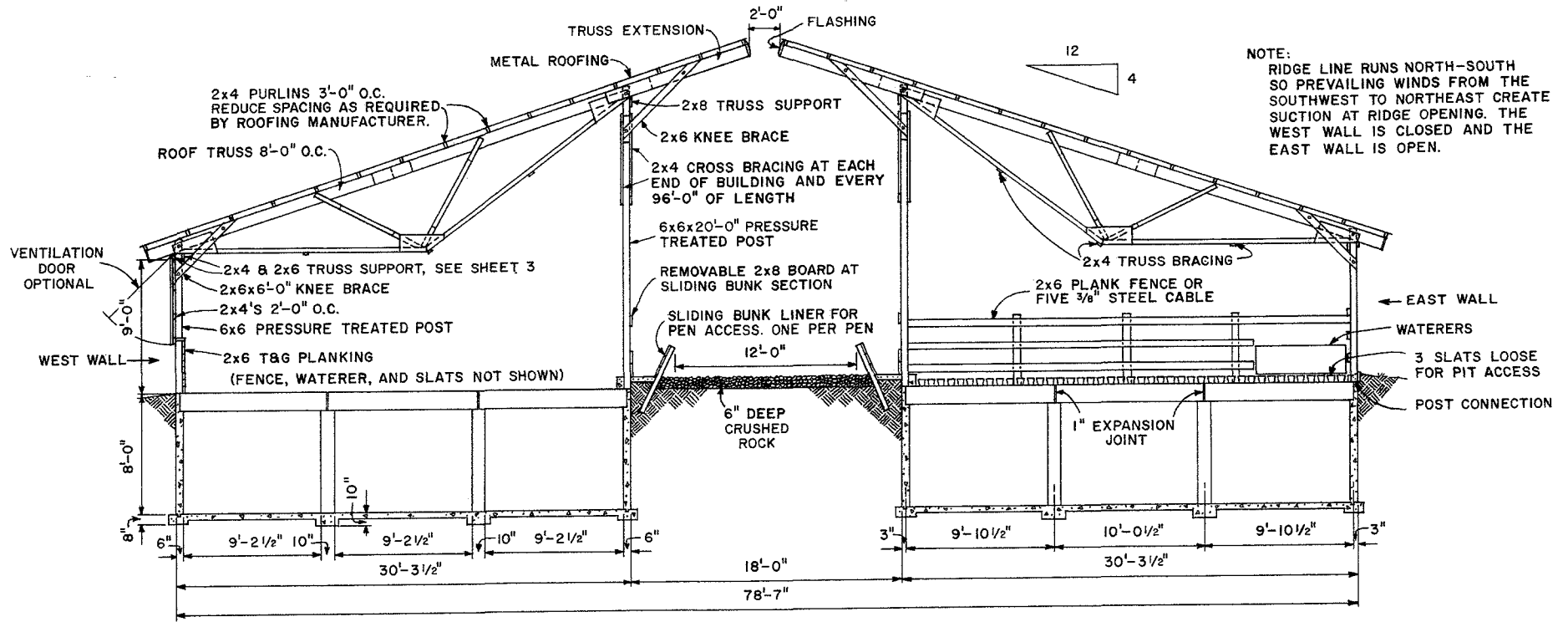

SECTION A-A  
SCALE: 3/8" = 1'-0"

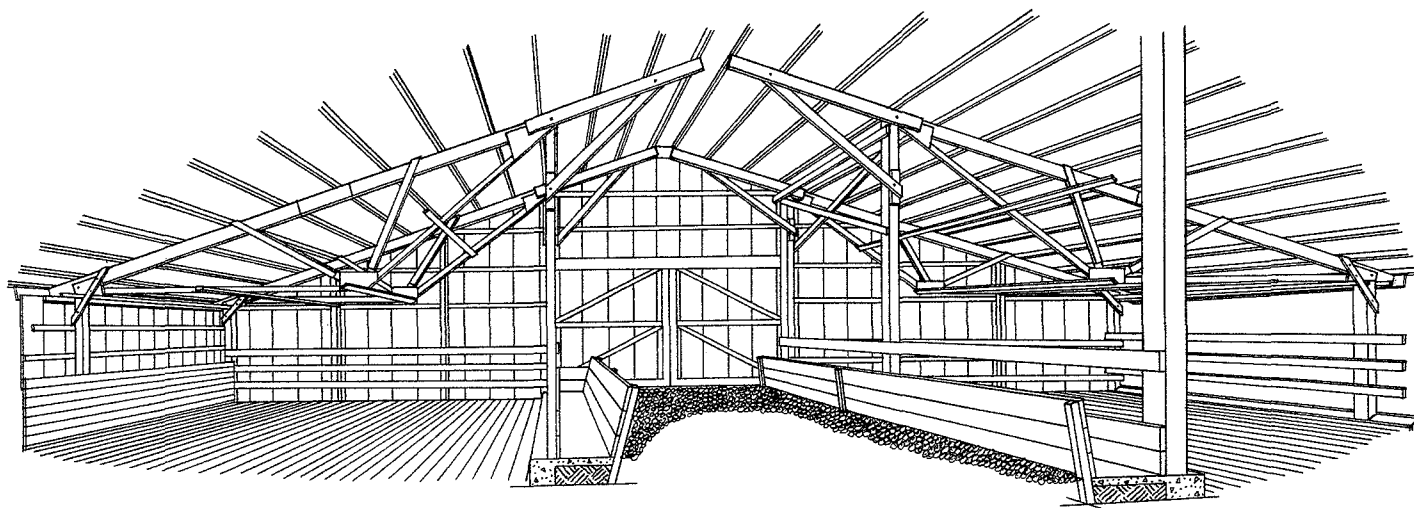

INTERIOR PERSPECTIVE



CONFINEMENT BEEF BARN

ILL. '73 6156 SHEET 2 OF 4





## Disclaimer

This site makes available conceptual plans that can be helpful in developing building layouts and selecting equipment for various agricultural applications. These plans do not necessarily represent the most current technology or construction codes. They are not construction plans and do not replace the need for competent design assistance in developing safe, legal and well-functioning agricultural building system. The LSU Agriculture Center, the Mid-West Plan Service, the United States Department of Agriculture and none of the cooperating land-grant universities warranty these plans.