

NOTES:

1. DIMENSIONS IN PARENTHESIS PERTAIN ONLY TO THE 14 FOOT HIGH PANEL.
2. SPECIFY MIN. 4000 PSI COMPRESSIVE STRENGTH CONCRETE, i.e. 6 GALLONS OF WATER PER SACK OF CEMENT, MIN. 7 SACKS OF CEMENT PER CU. YD. CONCRETE. USE 6% AIR ENTRAINMENT.
3. MINIMUM LAP FOR ALL REINFORCING SHALL BE 10"
4. CAST FLOOR IN LENGTHWISE STRIPS 10' WIDE.
5. USE POLYETHYLENE OR TREATED PAPER BOND BREAKER BETWEEN FLOOR & PANELS.
6. USE A VIBRATOR TO ELIMINATE VOIDS IN THE CONCRETE.
7. WET CURE PANELS 5 TO 7 DAYS BEFORE TILTING INTO PLACE.
APPROXIMATE PANEL WEIGHT (10 FT. - 3460 LBS.)
(14 FT. - 7630 LBS.)

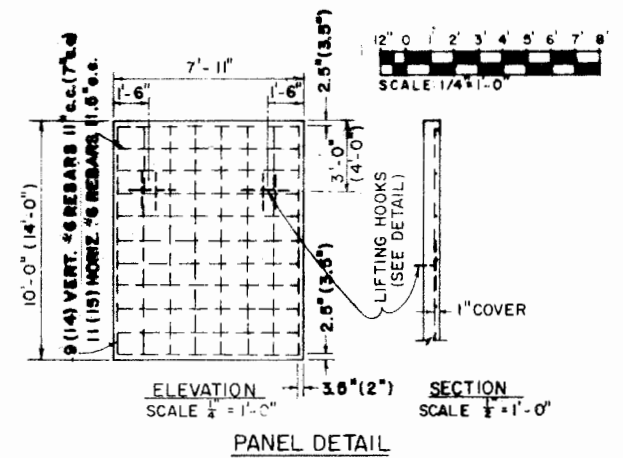

SILO CAPACITY - TONS/FT. OF LENGTH						
DEPTH	DENSITY	AVERAGE SILO WIDTH				
		20	30	40	50	60
10 FT.	40 ³ / _{FT.} ³	4	6	8	10	12
14 FT.	45 ³ / _{FT.} ³	6.3	9.4	12.6	15.8	18.9

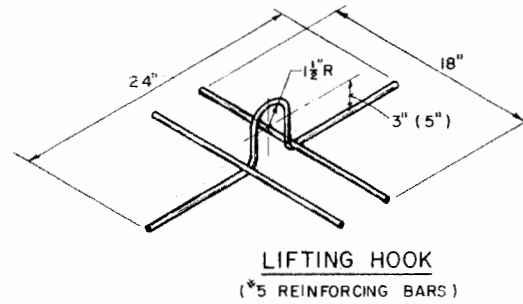
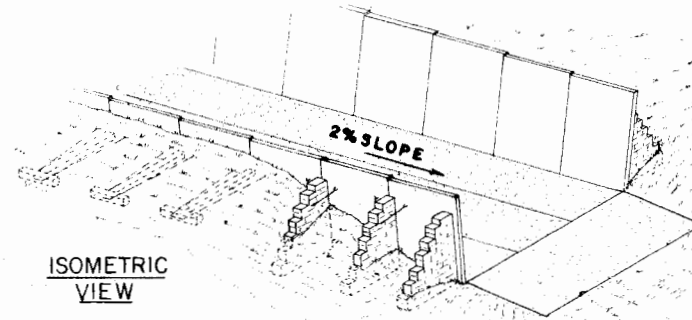

ISOMETRIC VIEW

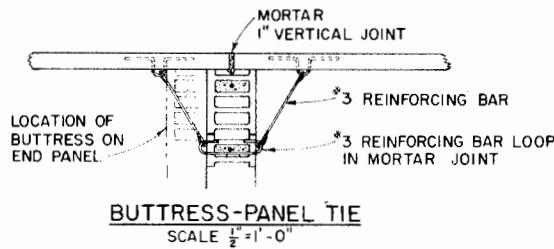

BUTTRESS-PANEL TIE
SCALE 1/2" = 1'-0"

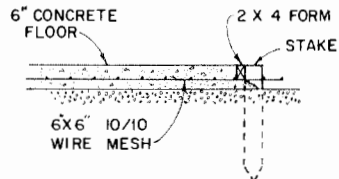

FORMING DETAIL FOR ADJOINING FLOOR STRIPS
SCALE 1/2" = 1'-0"

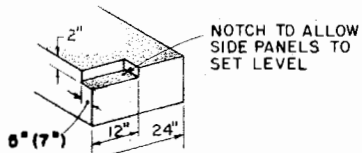

FOOTING DETAIL
SCALE 1/2" = 1'-0"

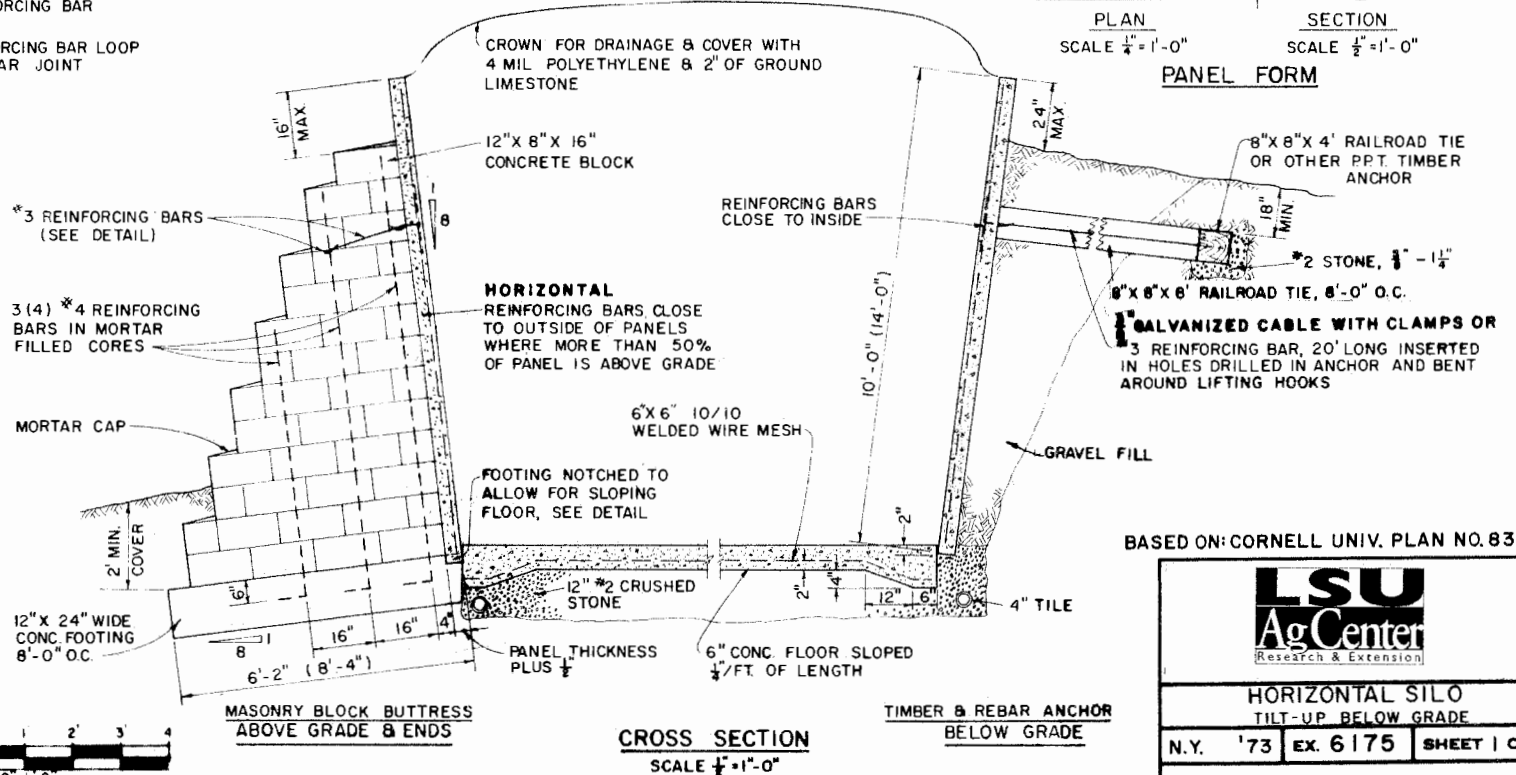
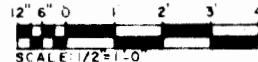

MASONRY BLOCK BUTTRESS ABOVE GRADE & ENDS

CROSS SECTION
SCALE 1/2" = 1'-0"

TIMBER & REBAR ANCHOR BELOW GRADE

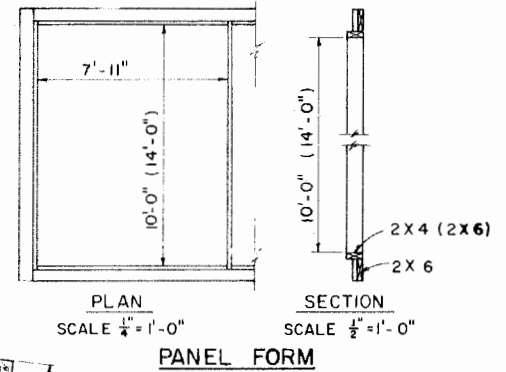

PANEL FORM

BASED ON: CORNELL UNIV. PLAN NO. 838

LSU
AgCenter
Research & Extension

HORIZONTAL SILO
TILT-UP BELOW GRADE

N.Y.	'73	EX. 6175	SHEET	1 OF 1
------	-----	----------	-------	--------

Disclaimer

This site makes available conceptual plans that can be helpful in developing building layouts and selecting equipment for various agricultural applications. These plans do not necessarily represent the most current technology or construction codes. They are not construction plans and do not replace the need for competent design assistance in developing safe, legal and well-functioning agricultural building system. The LSU Agriculture Center, the Mid-West Plan Service, the United States Department of Agriculture and none of the cooperating land-grant universities warranty these plans.